

MTH600 Double Tom Holder
MTH600BN Double Tom Holder (Black Nickel)
MTH600N Double Tom Holder (for Superstar Classic)

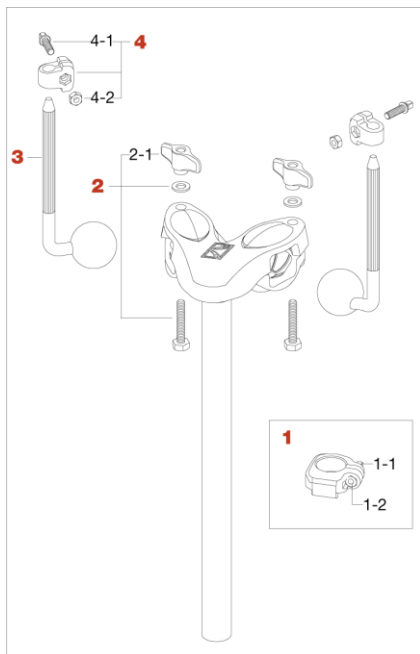

MTH600 (Chrome plated)

Production since Jun. 2006

No.	Model No.	Description
1	ML254TC	Memory Lock (Φ25.4mm)
1-1	MS620SH	Square head bolt (M6x20mm)
1-2	NT6	Nut (M6)
2	HB850WN8W	Bolt (M8x50mm), washer & nut assembly
2-1	WN8P	Wing nut (M8, 2pcs/pack)
3	LOB	Omni-Ball rod
4	ML105	Key lock (10.5mm)
4-1	MS620SH	Square head bolt (M6x20mm)
4-2	NT6	Nut (M6)

MTH600BN (Black Nickel plated)

Production since Jun. 2017

No.	Model No.	Description
1	ML254TBN	Memory Lock (Φ25.4mm /BN)
1-1	MS620SHBN	Square head bolt (M6x20mm /BN)
1-2	NT6	Nut (M6)
2	HB850WN8WB	Bolt (M8x50mm), washer & nut assembly (BN)
2-1	WN8BNP	Wing nut (M8, 2pcs/pack /BN)
3	LOBBN	Omni-Ball rod (BN)
4	ML105BN	Key lock (10.5mm /BN)
4-1	MS620SHBN	Square head bolt (M6x20mm /BN)
4-2	NT6	Nut (M6)

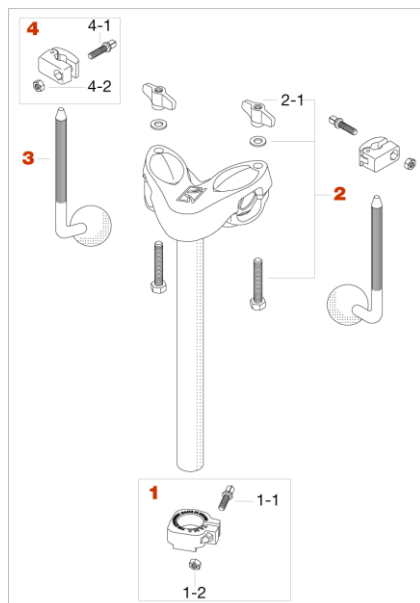

MTH600N (for Superstar Classic / Chrome plated)

Production since Nov. 2014

No.	Model No.	Description
1	ML254TC	Key lock for tom holder (25.4mm)
1-1	MS620SH	Square head bolt (M6x20mm)
1-2	NT6	Nut (M6)
2	HB850WN8W	Bolt, washer & nut assembly
2-1	WN8P	Wing nut (M8, 2pcs/pack)
3	LOB	Omni-Ball rod
4	ML11	Memory lock (Hinge Type, for MTB25)
4-1	MS620SH	Square head bolt (M6x20mm)
4-2	NT6	Nut (M6)