

**MTH1000 Double Tom Holder (Chrome)**  
**MTH1000BN Double Tom Holder (Black Nickel)**  
**MTH1000U Double Tom Holder (Smoked Black Nickel)**

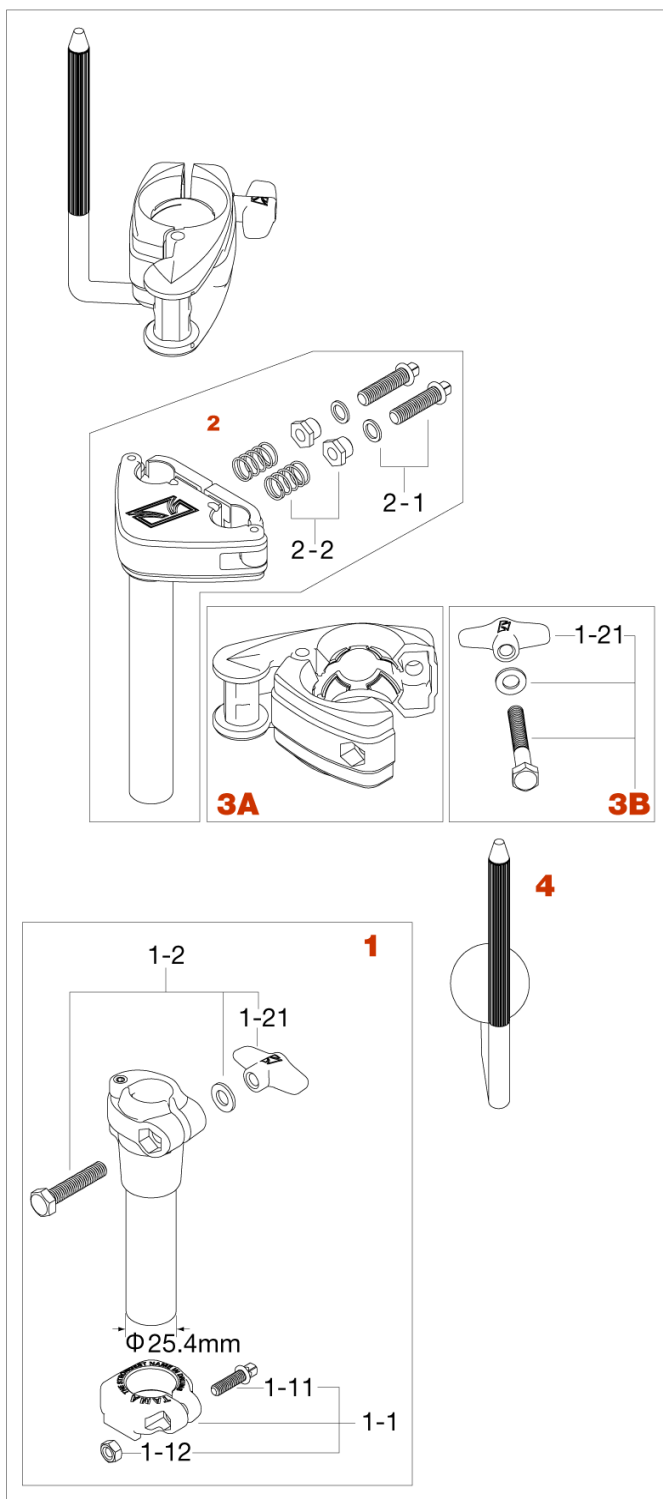

**MTH1000**

No.	Model No.	Description
<b>1</b>	MTH10001	<b>Base pipe</b>
1-1	ML254TC	Memory lock
1-11	MS620SH	Square head bolt (M6x20mm)
1-12	NT6	Nut (M6)
1-2	HB840TN8W	Bolt, washer & T-nut assembly
1-21	TN8P	M8 T-nut (2pcs)
<b>2</b>	MTH10002	<b>holder casting</b>
2-1	MSS830SW	Bolt & washer
2-2	IN8S	Insert nut & spring
<b>3A</b>	HTW109W22	<b>Tom holder casting</b>
<b>3B</b>	HB855TN8W	<b>Bolt (M8x55mm), T-nut &amp; washer assembly</b>
<b>4</b>	JOB	<b>J shaped Omni-Ball rod</b>

**MTH1000BN**

No.	Model No.	Description
<b>1</b>	MTH1000BN1	<b>Base pipe (BN)</b>
1-1	ML254TBN	Memory lock (BN)
1-11	MS620SHBN	Square head bolt (M6x20mm) (BN)
1-12	NT6	Nut (M6)
1-2	HB840TN8WB	Bolt, washer & T-nut assembly (BN)
1-21	TN8BNP	M8 T-nut (2pcs)(BN)
<b>2</b>	MTH1000BN2	<b>holder casting (BN)</b>
2-1	MSS830SWBN	Bolt & washer (BN)
2-2	IN8S	Insert nut & spring
<b>3A</b>	HTW109W22B	<b>Tom holder casting(BN)</b>
<b>3B</b>	HB855TN8WB	<b>Bolt (M8x55mm), T-nut &amp; washer assembly (BN)</b>
<b>4</b>	JOBBN	<b>J shaped Omni-Ball rod (BN)</b>

**MTH1000U**

Production 2016/11-

No.	Model No.	Description
<b>1</b>	MTH1000U1	<b>Base pipe (U)</b>
1-1	ML254TU	Memory lock (U)
1-11	MS620SHBN	Square head bolt (M6x20mm) (BN)
1-12	NT6	Nut (M6)
1-2	HB840TN8WU	Bolt, washer & T-nut assembly (U)
1-21	TN8UP	M8 T-nut (2pcs) (U)
<b>2</b>	MTH1000U2	<b>holder casting (U)</b>
2-1	MSS830SWBN	Bolt & washer (BN)
2-2	IN8S	Insert nut & spring
<b>3A</b>	HTW109W22U	<b>Tom holder casting(U)</b>
<b>3B</b>	HB855TN8WU	<b>Bolt (M8x55mm), T-nut &amp; washer assembly (U)</b>
<b>4</b>	JOBU	<b>J shaped Omni-Ball rod (U)</b>