

**HP900P,HP900R,HP900F Iron Cobra Pedal : Power Glide, Rolling Glide, Flexi Glide
<Discontinued>**

Production from Feb. 2004 to Dec. 2016

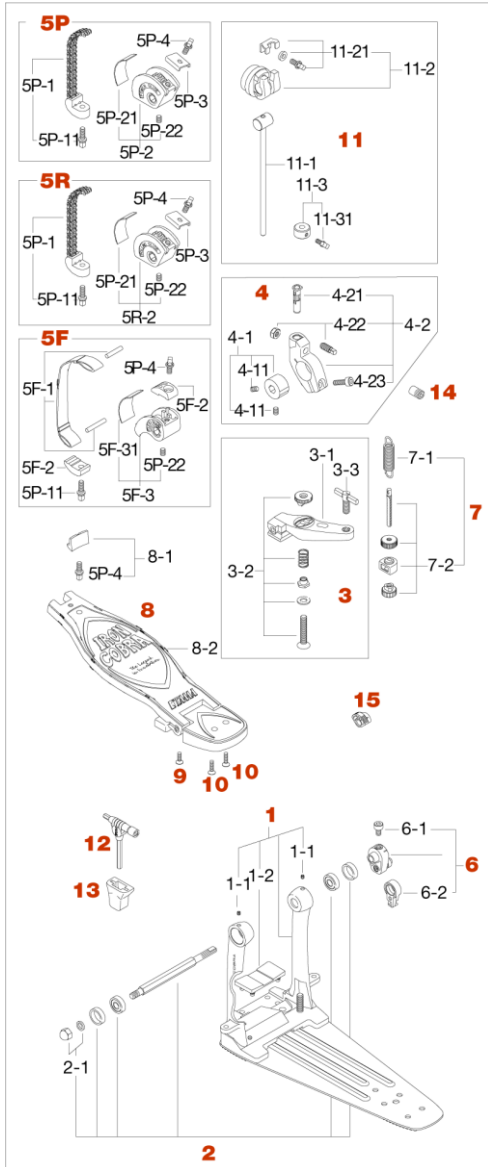

No.	Model No.	Substitutable Model No.	Description
1	HP9-1N (Discontinued)	HP90F (Frame) (Needs to replace below parts together) HP92N (Shaft assembly) HP99N (Stabilizing plate)	Frame & Stabilizing plate
1-1	S45		Screw (M4x5mm)
1-2	HP9-12		Rubber plate
2	HP9-2		Shaft assembly
2-1	HP9-21		Acorn hex nut & washer
3	HP9-3 (Discontinued)	HP9N3	Para clamp II Pro assembly
3-1	HP9-31 (Discontinued)	HP9N31	Clamp casting
3-2	HP9-32		Bolt (M8x45mm), spring, washer, spacer & nut assembly
3-3	WS820 (Discontinued)	WS826	T-bolt (M8x26mm)
4	HP9-4 (Discontinued)	HP914	Vari-Pitch beater holder complete
4-1	HP9-41		Vari-Pitch beater holder center casting w/screws
4-11	S68		Screw (M6x8mm)
4-2	HP9-42 (Discontinued)	HP9142	Vari-Pitch beater holder outer casting w/screws
4-21	NBB		Nylon bush
4-22	S816SHN		Square head bolt (M8x16mm) w/nut
4-23	L620		Screw (M6x20mm)
5P	HP9-5P (Discontinued)	HP95PN	Power Glide sprocket (for HP900P) & chain assembly
5P-1	HP9-53		Chain assembly w/screw
5P-11	MS615SH		Square head bolt (M6x15mm)
5P-2	HP9-51P		Sprocket only w/screw
5P-21	FP-C		Felt pad for chain pedal
5P-22	S68		Screw (M6x8mm)
5P-3	HP9-54		Pressure plate
5P-4	MS612SH		Square head bolt (M6x12mm)
5R	HP9-5R (Discontinued)	HP95RN	Rolling Glide sprocket (for HP900R) & chain assembly
5R-2	HP9-51R		Sprocket only w/screw
5F	HP9-5F (Discontinued)	N/A	Flexi Glide rocker piece (for HP900F) & strap assembly
5F-1	HP9-53F		Strap w/ shafts
5F-2	HP9-54F		Pressure casting
5F-3	HP9-51F (Discontinued)	N/A	Rocker piece only w/screw
5F-31	FP-F		Felt pad for strap pedal
6	HP9-6N (Discontinued)	HP9SN	Speedo-Ring w/ Quick Hook
6-1	L610 (Discontinued)	L612C	Screw (M6x12mm)
6-2	HP9-71		Quick Hook only
7	HP9-7N		Spring assembly w/o Quick Hook
7-1	HP900-7R		Spring (Regular)
7-2	HP900-77		Spring Tight assembly
8	HP9-8 (Discontinued)	N/A	Footboard assembly
8-1	HP900-81		Toe stopper w/screw
8-2	HP9-82 (Discontinued)	HP908	Footboard only
9	S512		Screw (M5x12mm)
10	S516		Screw (M5x16mm)
11	CB90F		Iron Cobra beater (felt)
11-1	CB90-1		Shaft only
11-2	CB90FH		Beater head (felt)
11-21	CB90-2		Bolt (M6x12mm), washer & metal hook assembly
11-3	BC7		Beater balance adjuster
11-31	S58		Screw (M5x8mm)
12	DH7		Drum Hammer
13	HH5		Hammer Holder
14	TLK5		Tight Lock
15	AMC2		Angle memory cap