

Cymbal Attachment CA30EN / CA45EN

Production from 2005 to Oct. 2009

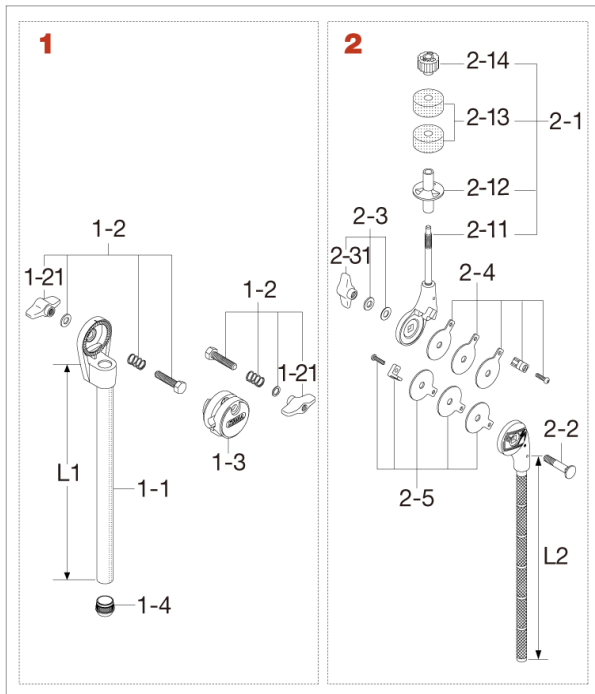

No.	Model No.	Substitutable Model No.	Description
1	MTA30 <i>(Discontinued)</i>	MTA30B	Ratchet arm (L1=300mm) for CA30EN
	MTA45 <i>(Discontinued)</i>	MTA45B	Ratchet arm (L1=450mm) for CA45EN
1-1	MTA30R-1		Tube only for MTA30
	MTA45R-1		Tube only for MTA45
1-2	HB835WN8T		Bolt (M8x35mm), spring, washer & nut assembly
1-21	WN8P		Wing nut (2pcs/pack)
1-3	HC83B-33		Pressure casting
1-4	IRC19S		Insert rubber cap (19.1mm)
2	MCB30EN		Boom arm (L2=300mm) for CA30EN
2	MCB45EN		Boom arm (L2=450mm) for CA45EN
2-1	CT44N		Cymbal tilter assembly
2-11	CT44-11N		Cymbal tilter only
2-12	RB8P		Cymbal bottom (2pcs/pack)
2-31	7081P		Felt washer (2pcs/pack)
2-14	CM8P		Fixing nut (M8, 2pcs/pack)
2-2	B840		Bolt (M8x40mm)
2-3	WN8WTW		T-nut (M8), washer, thin washer assembly
2-31	WN8P		Wing nut (2pcs/pack)
2-4	CT44-FPC		Friction plates (Chrome), plate and bolt assembly
2-5	CT44-FPB <i>(Discontinued)</i>	CT44-FPC	Friction plates (Black), plate and bolt assembly