

HP900PSN,HP900RSN,HP900FSN Iron Cobra Single Pedal : Power Glide, Rolling Glide, Flexi Glide <Discontinued>

Production from Mar. 2011 to Aug. 2015

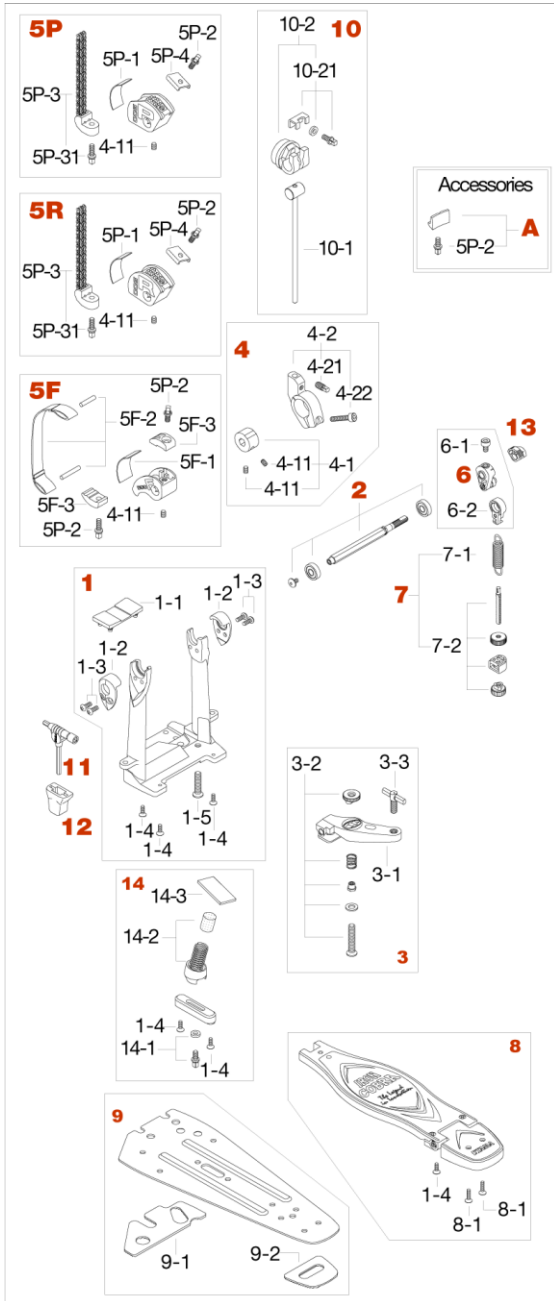

| No. | Model No. | Substitutable Model No. | Description |
|-------------|--------------------------|-------------------------|--|
| 1 | HP90F | | Frame assembly for 2011 Iron Cobra |
| 1-1 | HP9-12 | | Rubber plate |
| 1-2 | HP91F3 | | Metal bearing cover (1PC) |
| 1-3 | B512NP | | Screw (M5x12mm, nickel, 2pcs/set) |
| 1-4 | S512 | | Screw (M5x12mm) |
| 1-5 | L835 | | Screw (M8x35mm) |
| 2 | HP902 | | Shaft assembly |
| 3 | HP9-3 (Discontinued) | HP9N3 | Para clamp II Pro assembly |
| 3-1 | HP9-31 (Discontinued) | HP9N31 | Clamp casting |
| 3-2 | HP9-32 | | Bolt (M8x47mm), spring, washer, spacer & nut assembly |
| 3-3 | WS820 (Discontinued) | WS826 | T-bolt (M8x26mm) |
| 4 | HP914 | | Vari-Pitch beater holder complete |
| 4-1 | HP9-41 | | Vari-Pitch beater holder center casting w/screws |
| 4-11 | S68 | | Screw (M6x8mm) |
| 4-2 | HP9142 | | Vari-Pitch beater holder outer casting w/screws |
| 4-21 | S812SH | | Square head bolt (M8x12mm) |
| 4-22 | L620C | | Screw (M6x20mm, Chrome) |
| 5P | HP95PN | | Power Glide Cam assembly |
| 5P-1 | FP-C | | Felt pad for chain pedal |
| 5P-2 | MS612SH | | Square head bolt (M6x12mm) |
| 5P-3 | HP9-53 | | Chain assembly |
| 5P-31 | MS615SH | | Square head bolt (M6x15mm) |
| 5P-4 | HP9-54 | | Pressure plate |
| 5R | HP95RN (Discontinued) | N/A | Rolling Glide Cam assembly |
| 5F | HP95FN (Discontinued) | N/A | Flexi Glide Cam assembly |
| 5F-1 | FP-F | | Felt pad for strap pedal |
| 5F-2 | HP9-53F | | Strap w/ shafts |
| 5F-3 | HP9-54F | | Pressure casting |
| 6 | HP9SN | | Speedo-Ring w/ Quick Hook |
| 6-1 | L610 (Discontinued) | L612C | Screw (M6x12mm) |
| 6-2 | HP9-71 | | Quick Hook only |
| 7 | HP9-7N | | Spring assembly w/o Quick Hook |
| 7-1 | HP900-7R | | Spring only (Regular) |
| 7-2 | HP900-77 | | Spring Tight assembly |
| 8 | HP908 | | Footboard assembly |
| 8-1 | S516 | | Screw (M5x16mm) |
| 9* | HP909 | | Stabilizing plate complete |
| 9-1 | HP91102 | | Rubber plate for Speed Cobra & 2011 Iron Cobra pedal (front) |
| 9-2 | HP9093 | | Rubber plate for Speed Cobra & 2011 Iron Cobra pedal (rear) |
| 10 | CB90F | | Iron Cobra beater (felt) |
| 10-1 | CB90-1 | | Shaft only |
| 10-2 | CB90FH | | Beater head (felt) |
| 10-21 | CB90-2 | | Bolt (M6x12mm), washer & metal hook assembly |
| 11 | DH7 | | Drum Hammer |
| 12 | HH5 | | Hammer Holder |
| 13 | AMC2 | | Angle memory cap |
| 14 | CC900S | | Cobra Coil |
| 14-1 | MS612SHW | | Square head bolt (M6x12mm) w/washer |
| 14-2 | CC900S3 | | Cobra Coil spring assembly |
| 14-3 | FPCC | | Cobra Coil Felt for footboard |
| Accessories | | | |
| A | HP900-81 | | Toe stopper w /screw |

*9: HP909 can't work for replacement of below figured old plate.

