

# HC33BW Boom Cymbal Stand <Discontinued>

Production from Mar. 2015 to Dec. 2016

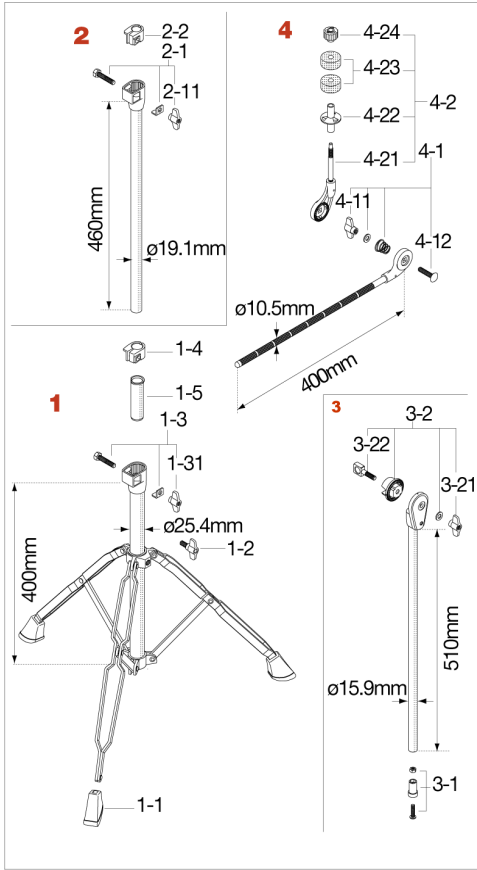

No.	Model No.	Description
<b>1</b>	HC32W1N	<b>Base assembly</b>
1-1	RF3WP3	Rubber tip (3pcs/set) for double braced leg
1-2	TS816P	T-bolt (M8x16mm, 2pcs/set)
1-3	HB840WN8L	Bolt (M8x40mm), L-plate, & nut assembly
1-31	WN8P	Wing nut (2pcs/set)
1-4	NB2219	Nylon bushing (25.4mm-19.1mm)
1-5	INS19N	Insert (Stabilizing) bushing (25.4mm-19.1mm)
<b>2</b>	HC32W2	<b>Center tube assembly</b>
2-1	HB840WN8L	Bolt (M8x40mm), L-plate, & nut assembly
2-11	WN8P	Wing nut (2pcs/set)
2-2	PB191H	Nylon bushing (19.1mm-15.9mm)
<b>3</b>	HC33BW3	<b>Upper tube assembly</b>
3-1	IRC15N	Insert rubber cap assembly
3-2	HC33BW32	Boom tilter assembly
3-21	WN8P	Wing nut (2pcs/set)
3-22	EBA830	Eye bolt (M8x30mm)
<b>4</b>	HC33BW4	<b>Upper rod w/ tilter</b>
4-1	B835WN8T	Bolt (M8x35mm), washer, spring & nut assembly
4-11	WN8P	Wing nut (2pcs/set)
4-12	B835	Bolt (M8x35mm)
4-2	CT33	Cymbal tilter assembly
4-21	CT331	Cymbal tilter only
4-22	RB8P	Cymbal bottom (2pcs/set)
4-23	7081P	Felt washer (2pcs/set)
4-24	CM8P	Cymbal mate (M8, 2pcs/set)