

# HC32W Cymbal Stand <Discontinued>

Production from May, 2006 to Feb. 2015

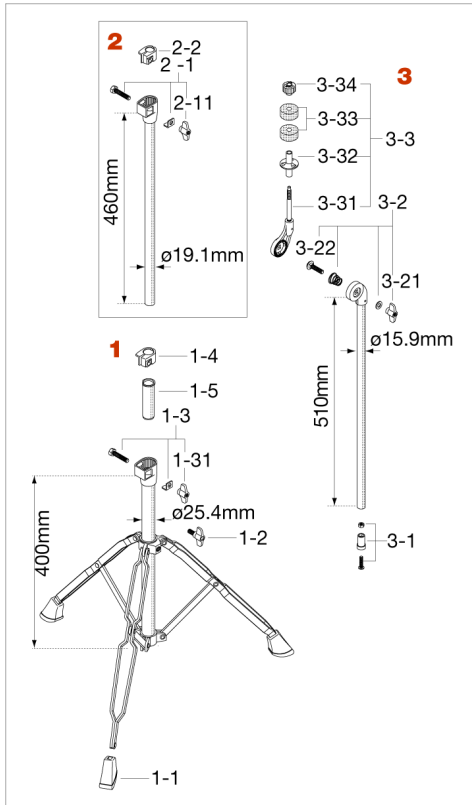

No.	Model No.	Description
<b>1</b>	<b>HC32W1</b>	<b>Base assembly</b>
1-1	RFDWP3	Rubber tip (3pcs/set) for double braced leg
1-2	TS816P	T-bolt (M8x16mm, 2pcs/set)
1-3	HB840WN8L	Bolt (M8x40mm), L-plate, & nut assembly
1-31	WN8P	Wing nut (2pcs/set)
1-4	NB2219	Nylon bushing (25.4mm-19.1mm)
1-5	INS19N	Insert (Stabilizing) bushing (25.4mm-19.1mm)
<b>2</b>	<b>HC32W2</b>	<b>Center tube assembly</b>
2-1	HB840WN8L	Bolt (M8x40mm), L-plate, & nut assembly
2-11	WN8P	Wing nut (2pcs/set)
2-2	PB191H	Nylon bushing (19.1mm-15.9mm)
<b>3</b>	<b>HC32W3</b>	<b>Upper tube assembly</b>
3-1	IRC15N	Insert rubber cap assembly
3-2	B835WN8T	Bolt (M8x35mm), washer, spring & nut assembly
3-21	WN8P	Wing nut (2pcs/set)
3-22	B835	Bolt (M8x35mm)
3-3	CT33	Cymbal tilter assembly
3-31	CT331	Cymbal tilter only
3-32	RB8P	Cymbal bottom (2pcs/set)
3-33	7081P	Felt washer (2pcs/set)
3-34	CM8P	Cymbal mate (M8, 2pcs/set)