

# HC32S Straight Cymbal Stand <Discontinued>

Production from Mar. 2015 to Dec. 2016

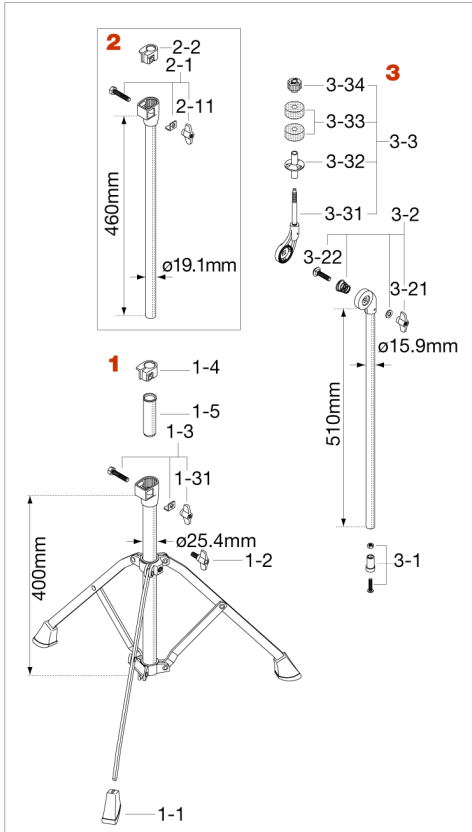

| No.      | Model No.      | Description                                   |
|----------|----------------|---|
| <b>1</b> | <b>HC32S1N</b> | <b>Base assembly</b>                          |
| 1-1      | RF3SP3         | Rubber tip (3pcs/set) for single braced leg   |
| 1-2      | TS816P         | T-bolt (M8x16mm, 2pcs/set)                    |
| 1-3      | HB840WN8L      | Bolt (M8x40mm), L-plate, & nut assembly       |
| 1-31     | WN8P           | Wing nut (2pcs/set)                           |
| 1-4      | NB2219         | Nylon bushing (25.4mm-19.1mm)                 |
| 1-5      | INS19N         | Insert (Stabilizing) bushing (25.4mm-19.1mm)  |
| <b>2</b> | <b>HC32W2</b>  | <b>Center tube assembly</b>                   |
| 2-1      | HB840WN8L      | Bolt (M8x40mm), L-plate, & nut assembly       |
| 2-11     | WN8P           | Wing nut (2pcs/set)                           |
| 2-2      | PB191H         | Nylon bushing (19.1mm-15.9mm)                 |
| <b>3</b> | <b>HC32W3</b>  | <b>Upper tube assembly</b>                    |
| 3-1      | IRC15N         | Insert rubber cap assembly                    |
| 3-2      | B835WN8T       | Bolt (M8x35mm), washer, spring & nut assembly |
| 3-21     | WN8P           | Wing nut (2pcs/set)                           |
| 3-22     | B835           | Bolt (M8x35mm)                                |
| 3-3      | CT33           | Cymbal tilter assembly                        |
| 3-31     | CT331          | Cymbal tilter only                            |
| 3-32     | RB8P           | Cymbal bottom (2pcs/set)                      |
| 3-33     | 7081P          | Felt washer (2pcs/set)                        |
| 3-34     | CM8P           | Cymbal mate (M8, 2pcs/set)                    |