

Cymbal Attachment CA30EN/CA45EN

Production since Nov. 2009

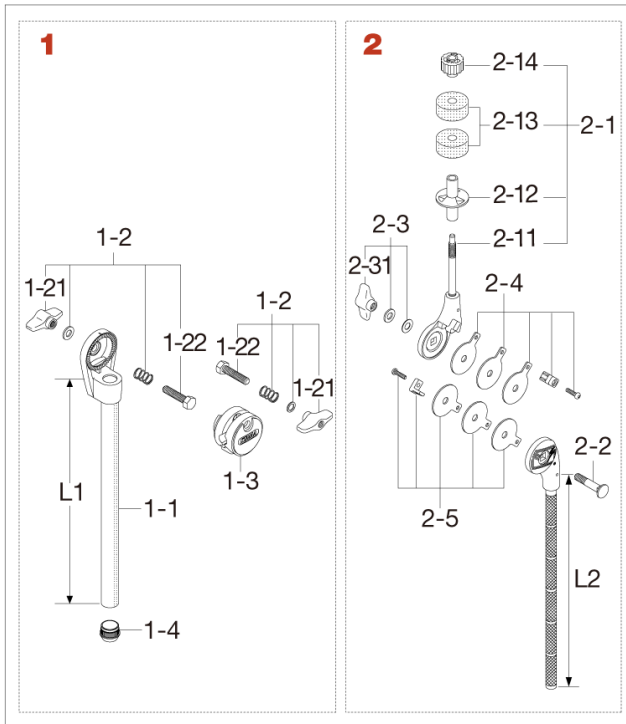

No.	Model No.	Description
1	MTA30	Ratchet arm (L1:300mm) for CA30EN
1	MTA45	Ratchet arm (L1:450mm) for CA45EN
1-1	MTA30R-1	Tube only for MTA30
	MTA45R-1	Tube only for MTA45
1-2	HB835WN8T	Bolt (M8x35mm), spring, washer & nut assembly
1-21	WN8P	Wing nut (2pcs/pack)
1-22	B835	Bolt (M8x35mm)
1-3	HC83B-33	Pressure casting
1-4	IRC19S	Insert rubber cap (19.1mm)
2	MCB30EN	Boom arm (L2:300mm) for CA30EN
2	MCB45EN	Boom arm (L2:450mm) for CA45EN
2-1	CT44Q	Cymbal tilter assembly
2-11	CT44-11N	Cymbal tilter only
2-12	RB8P	Cymbal bottom (2pcs/pack)
2-31	7081P	Felt washer (2pcs/pack)
2-14	QC8	Quick set cymbal mate
2-2	B840	Bolt (M8x40mm)
2-3	WN8WTW	T-nut (M8), washer, thin washer assembly
2-31	WN8P	Wing nut (2pcs/pack)
2-4	CT44-FPC	Friction plates (Chrome), plate and bolt assembly
2-5	CT44-FPB	Friction plates (Black), plate and bolt assembly